

HOME DESIGN EXPO 2014



Ferreiras
Tile + Bathroom

Out of the Ordinary™

 Investec



Waterfall

• COUNTRY LIFESTYLE ESTATE •

HOME DESIGN

07



DEVILLIERS
DU TOIT
ARCHITECTS

LU^hAL
CONSTRUCTION
Quality, on Time.

► ARCHITECT

Devilliers du Toit Architects

► BUILDER

Lumal Construction

► SPECS

- House size: 646.3m²
- Double volume entrance hall
- 4x Bedroom suites
- 1x Guest suite / home office
- 3x Living rooms
- Vast covered veranda with bar
- Kitchen, scullery & pantry
- Wine cellar
- Full domestic suite
- Triple garage and store

HOME DESIGN

07

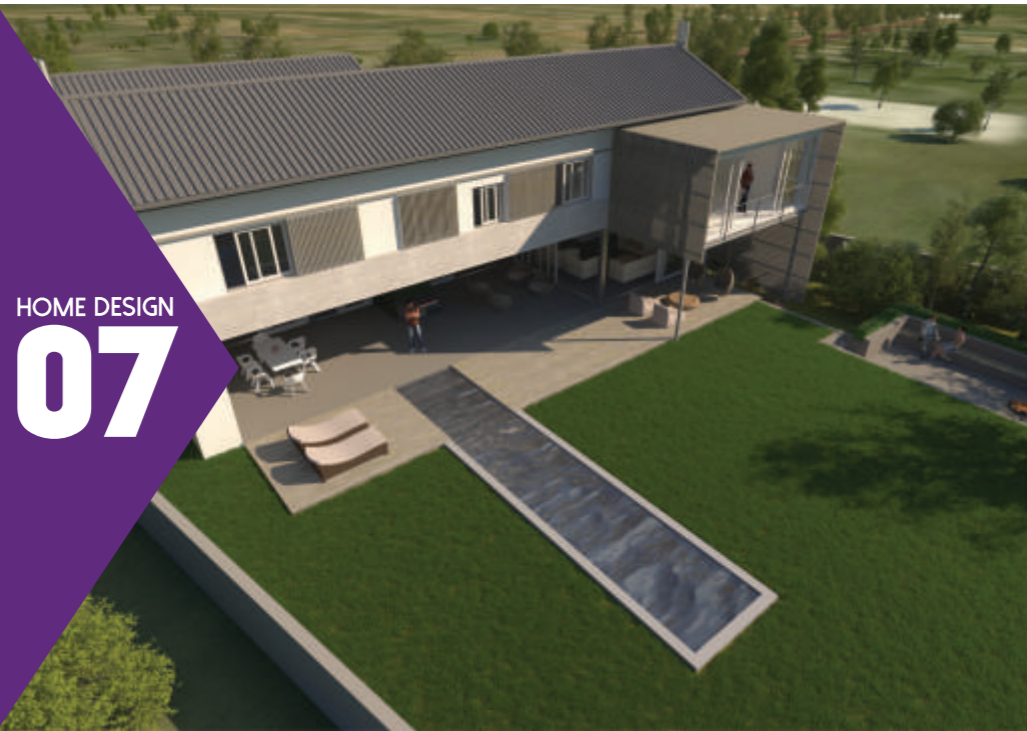

INNOVATION & GREEN DESIGN

Rain water harvesting will be well integrated with highly efficient drip irrigation to make full use of the rain whilst minimising municipal water use and storm water runoff. Dependence on electricity will be reduced by use of a photovoltaic system and solar hot water panels. The use of LP gas cooking appliances and high efficiency wood and pellet burning stoves for internal climate management also reduces energy consumption.

The most important part to energy saving is, however, passive design. The house orientation is correct, directly north. The windows will have low emissivity glass, and window sizes are kept reasonable. The roofs are maximally insulated and it is recommended that the walls have an insulated cavity.



► FEATURING AN EXTRA LENGTH LAP POOL AND AN INDIGENOUS LANDSCAPED GARDEN



HOME DESCRIPTION

The home we designed has at its root the principles of simplicity, openness and environmental consciousness. Spaces and functions flow seamlessly opening up towards the minimal garden with a green area as the backdrop. The path through the home is suggested by a water feature flowing towards the main entrance tying in with the long narrow pool. The house is positioned on an east-west axis facing directly north with a spacious veranda opening up onto nature. The view is framed by an off-shutter wood grain textured concrete ceiling above and an extra length lap pool and landscaped garden below. The outdoor experience is accentuated with a private, sunken fire pit amid a small grove of indigenous trees.

The relationship between nature and home is subtly reinforced throughout the house, with large, horizontally oriented windows, and stacking doors overlooking the view. Large gable windows bring in natural light and allow views of the sky.

The principal materials used in the design are concrete and timber on a backdrop of smooth plaster in a palette of light tones and greys. The colours deflect the harsh summer sun while creating a striking and simple modern aesthetic. The house elegantly engages with its natural surroundings while minimising its impact on the environment.



DEVILLIERS DU TOIT ARCHITECTS

Devilliers du Toit Architects was founded in 2011 and is led by Devilliers du Toit, who, with more than 15 years' experience in the realms of residential and commercial architecture, is well equipped to guide you, as client, through the intricacies of design and construction. He is also mindful of the environment and has experience with 'green design' as a member of the Green Building Council of SA and is a US Green Building Council LEED Green Associate.

We believe that elegant and timeless, yet modern architecture, executed in a sustainable and environmentally conscious manner is a basic need in our hurried modern lifestyle. Your home is a sanctuary and when designed by a professional who has your best interest at heart, and the experience necessary to translate your dreams into reality, it fulfils that purpose so much more effectively. Our firm delivers a very personal, client oriented service which enables us to live up to your every expectation.

Waterfall
• COUNTRY LIFESTYLE ESTATE •

This home was specifically designed to fit into this prestigious lifestyle estate. It conforms to Waterfall's uniquely South African style of architecture which embraces "green living" and open space.

For more information on this estate or to arrange an exclusive meeting please feel free to contact one of our representatives.

Norman: 082 903 7502
Musi: 082 806 1735
Francis: 082 806 1769



► SIMPLICITY, OPENNESS AND ENVIRONMENTAL CONSCIOUSNESS

LUMAL CONSTRUCTION

Lumal is a 40 year old construction firm, now based and building at Waterfall. We offer both contract and building packages for luxury homes. The homes we build are the physical representation of our clients' dreams for their future and we put our effort into ensuring that our work lives up to these expectations.

Our team is highly qualified and experienced. We go beyond the traditional building service to advise our clients on cost reductions, green building, improving maintainability and enhancing the overall design. Our commitment to service ensures the smooth running of our projects and makes the experience of building your own home enjoyable. Partnerships with an extensive network of suppliers enables us to help source the best discounts, quality and service with PC items. We strive for the highest quality output and have an enviable track record of delivery on time. If you are building at Waterfall, Lumal is undoubtedly the smartest choice.

CONTACT

► **Devilliers du Toit Architects**
www.devilliersdutoit.com
Devilliers du Toit
devilliers@devilliersdutoit.com
083 232 6554

► **Lumal Construction**
www.lumal.co.za
Carl Marais
info@lumal.co.za
010 591 4723



HOME DESIGN

07

SPONSORS



- ▶ **Bathroom Bizarre**
www.bathroom.co.za
Shane Chetty
shanec@bathroom.co.za
011 372 4000



- ▶ **SolarPV Projects**
Renzo Blasa
renzo@blasa.co.za
083 408 5340



- ▶ **The Garden Group**
www.garden-group.co.za
Nico du Toit
gardengroup@intekom.co.za
012 804 1807



- ▶ **Hot Orange Design Projects**
Heidi Fenton
heidi@hotorangedesignprojects.co.za
082 374 0898



- ▶ **Pick a Kitchen**
www.pickakitchen.co.za
Raymond te Vaarwaak
raypickakitchen@gmail.com
011 867 6045



- ▶ **Lightz by William**
Midrand | Greenstone
William
lightzbywilliam@iburst.co.za
011 318 0866/7

HOME
DESIGN
EXPO 2014



www.century.co.za